

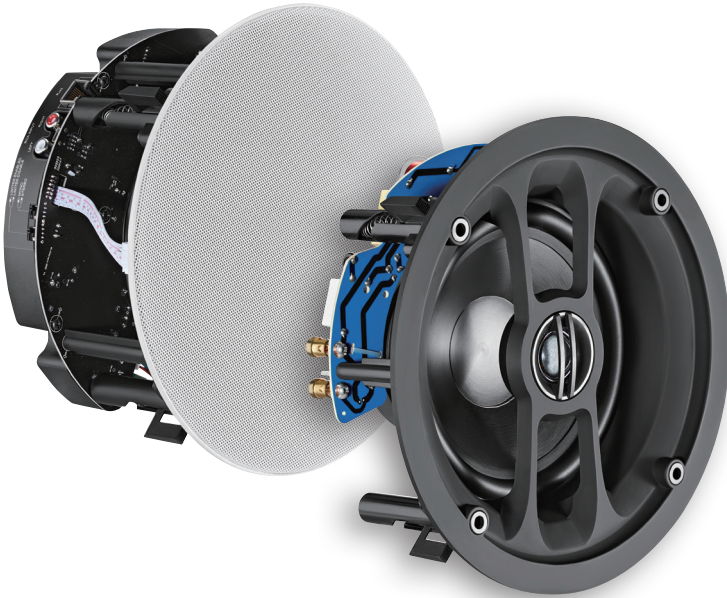

# C 0870A

## **165mm 2-Way Round Wi-Fi Ceiling Speaker Pair** Operating Instructions



### **Features**

- In-built wifi (802.11b/g/n) 2.4GHz with smartphone, tablet or PC control.
- In-built 2 x 30W RMS amplifier.
- Includes active [Master] speaker and passive [Slave] speaker units - 60W RMS total.
- High performance Polypropylene woofer and silk dome tweeter.
- Supports multi-room/zone installations.
- In-app content, zone and output level control [Smartsonix].
- Includes 24V d.c. 2.5A power supply.

# C 0870A 165mm 2 Way Round WiFi Ceiling Speaker Pair

## Introduction

Experience wireless music streaming throughout your home with these high-performance Polypropylene cone speakers. They connect to your home's wireless router and allow you to stream music directly from your Wi-Fi enabled devices. Playback can be via stored music, podcasts, Spotify or other music streaming services. The 'Smartsonix' app is available on iOS or Android. You can have up to 10 speaker sets spread across different rooms in your premises (zones), all being controlled through the 'Smartsonix' application's zone management features. Speakers are also compatible with Apple Airplay, thereby permitting easy audio streaming directly from a huge array of iOS and Mac app store applications. Sold in pairs.

## Specifications

Speaker	Active Speaker	Passive Speaker
Woofer	165mm (6.5") Polypropylene	165mm (6.5") Polypropylene
Tweeter	19mm (0.75") Silk Dome	19mm (0.75") Silk Dome
Frequency response	70Hz-20KHz	70Hz-20KHz
Sensitivity (1w/1m)	87dB	87dB
Impedance (Nominal)	8 ohms	8 ohms
RMS Power	30W/8Ω	30W/8Ω
Audio Input	RCA	Binding post
Dimensions (mm)	Ø233 x 105mm	Ø233 x 105mm
Amplifier		
Type	Class 'D' (digital)	/
Rated Power	2x 30W RMS per channel	/
Power Input	24V d.c. 2.5A (Adapter included)	/
Built-in WiFi Hotspot		
Wireless network compatibility	802.11b/g/n 2.4GHz	/
Supported audio format	MP3/WMA/AAC/ACC/ACC+/ALAC/APE/WAV	/
Wireless Range	80m	/

## Inside the Package

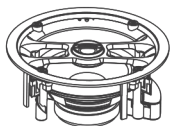

Active Speaker



User Manual



Remote Control

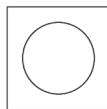

Cutout Template

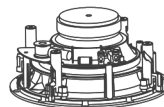

Passive Speaker

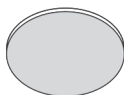

Grill x2



Power Cord with Adapter



Installation Tool

# C 0870A 165mm 2 Way Round WiFi Ceiling Speaker Pair

## WiFi Speaker Installation

### Equipment you will need:

Besides the cut-out template that is included in the box, we recommend having using the following equipment; Cutting Saw, Wire Strippers, Power drill, pencil, tape measure, stud finder, safety goggles and a ladder. Please follow the instructions below to guarantee a safe and efficient installation.

#### 1. Cut the Speaker Hole

Position the cutout template where you are installing the speaker. Trace the template to mark out the speaker location with a pencil. Drill a pilot hole and cut all of the way around the circular outline with a cutting saw.

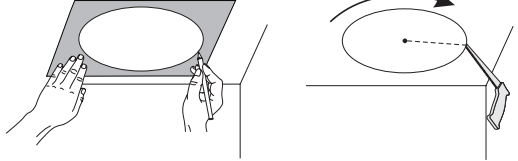

#### 2. Wire the Speaker

Connect the adapter and RCA cables (if needed) to the corresponding ports.

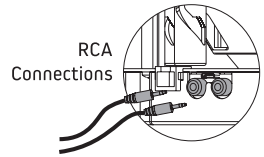
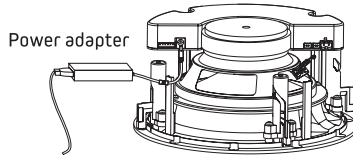

#### 3. Install the Speaker

Adjust the dog leg with the installation tool as shown and insert the speaker into the hole.

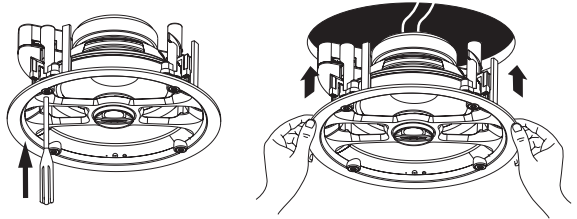

#### 4. Lock the Speaker

Lock the speaker by pressing the buttons located on the front face of the speaker and the dog leg will engage automatically.

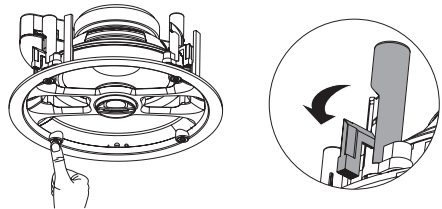

#### 5. Attach the Grill

Paint the speaker grill to match your room décor before you attach them to the speaker. As several magnets are on the speaker frame, attach the grill to the rim of the speaker directly. Ensure the grill is attached to the speaker securely to keep the grill from falling.

**Note:** Paints and spray gun are not included.

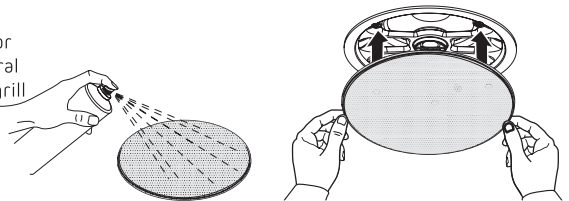

# C 0870A 165mm 2 Way Round WiFi Ceiling Speaker Pair

## Speaker Overview

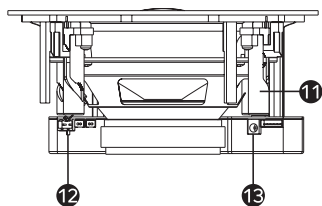
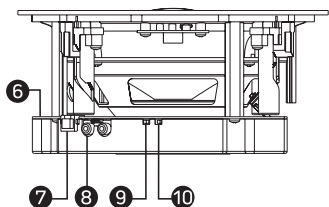
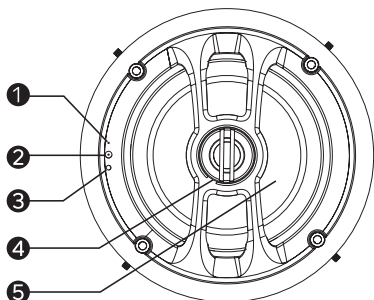

100mm ceiling depth required

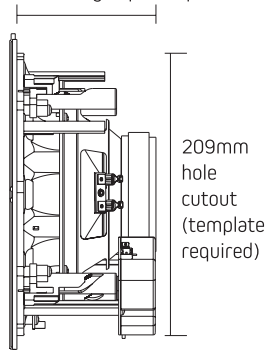

- 1 LED Indicator**  
Slowly flashing red: power on or reset.  
Steady red: the Internet module is ready to connect.  
Slowly flashing green: Wi-Fi is connecting.  
Steady green: Wi-Fi is connected.  
Steady cyan: Current audio source is RCA.  
Flashing red, green and blue: The system is updating or resetting.
- 2 IR Receiver**
- 3 Reset Button**
  1. Press it to switch play mode.
  2. Press it for 3 seconds to start connecting to the Internet.
  3. Press it for more than 10 seconds to start resetting with flashing red, green and blue light.
- 4 Pivoting Tweeter**
- 5 Woofer**
- 6 Built-in Amplifier**
- 7 RJ45 Ethernet Port**
- 8 RCA Jack**
- 9 Stereo/Mono Switch**  
Switch to the "stereo" position when a passive speaker is attached. If not, keep in "mono" position.
- 10 Volume Limiter**
  - Limiter Enabled(50%): The volume will be limited to the max. output 15W@8Ω.
  - Limiter Disable(100%): The volume can be adjusted to the max. output 30W@8Ω.
- 11 Quick-Install Dog Leg Fixings**
- 12 Speaker Output**
- 13 Power Inlet (DC 24V/2.5A)**

# C 0870A 165mm 2 Way Round WiFi Ceiling Speaker Pair

## Caution: Speaker Network Setup

It is recommended to power on and connect the speakers with the premises Wi-Fi network before mounting speakers in the ceiling. This will allow easier access to the WPS button and confirm compatibility with the premises network.

## Wi-Fi speaker setup:

### Method 1 – App connection (iOS & Android devices)

#### Step 1: Installing Controller APP

- Search the Google play (Android) or App Store (iOS) to download the controller app called 'Smartsonix'

#### Step 2: Connecting the Wi-Fi Speaker

- Ensure the speaker is connected to the power supply. Press the WPS button to start the speaker, then you will hear an instruction "Enter the setup mode, follow the instructions in the APP to finish the setup", and the power indicator flashes green indicating that the speaker is ready to connect. Any wireless device (such as phones, tablets, laptops etc.) can be connected. Once connected successfully, the power indicator will become steady green.

1. Turn on the Wi-Fi function and connect your phone to an available Wi-Fi network that you want.

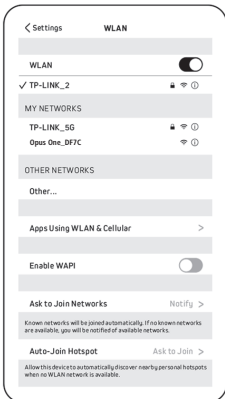

2. Start the controller APP Smart Sonix and click Add Device

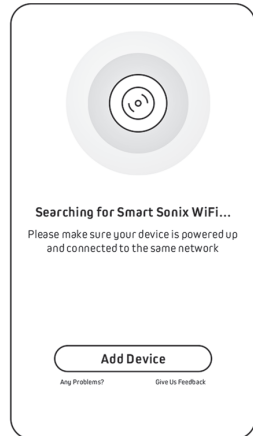

# C 0870A 165mm 2 Way Round WiFi Ceiling Speaker Pair

3. Follow the instructions in the app and get to your phone Wi-Fi settings to find the “Opus One\_\*\*\*\*\*” in the network list and connect it.

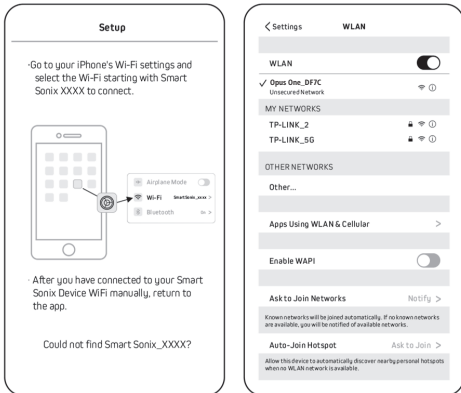

## Notes:

- When the Wi-Fi ceiling speaker is first powered on, a WiFi connection is the first thing for which the speaker searches. If no wireless device is found on whilst connecting, the speaker will activate the RCA input after 5~20 seconds in standby.
- Wi-Fi input has the priority when Wi-Fi input and RCA input are connected simultaneously. If the wireless device stops streaming for 5 seconds or more, then the speaker will switch to RCA input if it is connected.
- The initial app password is “C0870AAA”, which can be reset in the Smart Sonix App.
- If the multi-room network fails the first time, restart all the equipment and then follow the standard connecting instructions. If trouble persists, press the “WPS button” located on the front of the speaker to reset the system. Make sure the speaker is powered during the reset.
- The wireless connection will be lost if the distance between the speaker and the wireless device exceeds 80m.

4. Return to the Smart Sonix. Choose the Wi-Fi the same as the one connected in step 1, type the password of the Wi-Fi and click Continue.



5. Wait for few seconds, the device will be connected to the Wi-Fi automatically. Note: After connecting successfully, click Next.

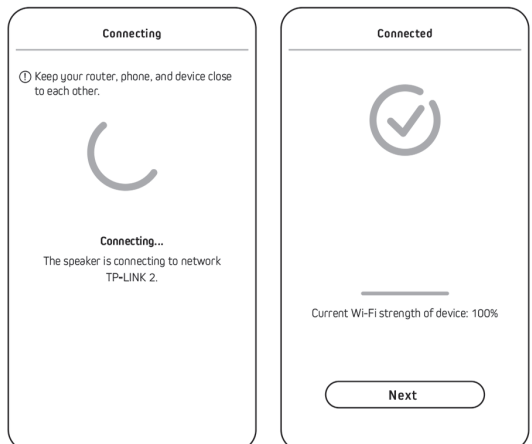

# C 0870A 165mm 2 Way Round WiFi Ceiling Speaker Pair

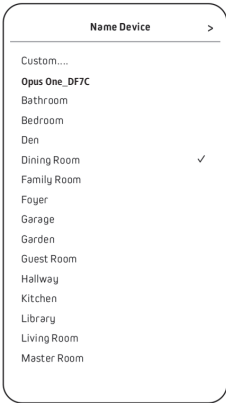

6. Name the device according to the room you will install and click >.



7. After finishing above settings, the Wi-Fi speaker will be in the device list, If you have more than one Wi-Fi speakers, press + to add devices and name them accordingly. After these steps, your multi-room music network is successfully established.

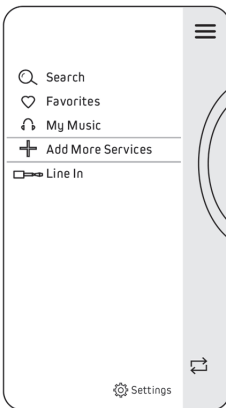

8. Choose a device and play a song in you phone to test whether the device works. If ok, testing is finished and you can proceed to use the speaker.

## Alternative App Note:

In a minority of cases we have found some customers having wi-fi compatibility issues. Alternative apps are available on both the Google play and Apple app stores. Search for “LegacyPlayer” on Android devices and “4 Stream” on Apple devices. Links to these are available from the Altronics website.

## Airplay Note:

For iPhone, iPad and iMac smart device with iOS operating system, you can use the Wi-Fi speaker through the Airplay function. Connect your device to the speaker Wi-Fi. In the pull-up or pull-down menu, click Airplay and choose the Wi-Fi speaker, then the audio can be streamed from your smart device.

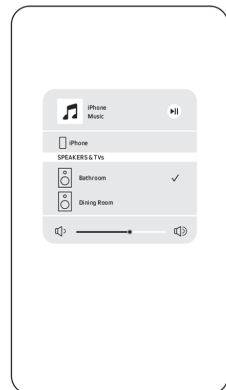
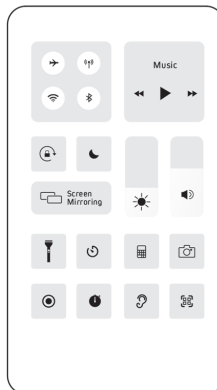

# C 0870A 165mm 2 Way Round WiFi Ceiling Speaker Pair

## Notes:

- When using an Ethernet Cable to connect the speaker to the router, the router must not have any special setting such as assigned IP or banned UPNP.
- The Wi-Fi ceiling speaker executes the Wi-Fi connecting first when the speaker is powered up.
- Wi-Fi input has the priority when Wi-Fi input and RCA input are connected simultaneously.
- If the multi-room network fails the first time, restart all the equipment and then follow the previous instructions. If trouble persists, press the “WPS button” located on the front of the speaker.
- The wireless connection will be lost if the distance between the speaker and the wireless device exceeds 80m

## Method 2 – RCA Connection

**Step 1:** Connect to the speaker using a dual RCA left/right cable

**Step 2:** Use the remote or SmartSonix app to choose RCA mode (Wi-Fi input has the priority when 2 audio inputs are connected simultaneously).

**Step 3:** The RCA mode will be activated when the indicator light shows cyan

## Method 3 – Create stereo pair

**Step 1:** Connect the passive speaker to the phoenix connector output

**Step 2:** Slide the mono-stereo switch to the stereo position

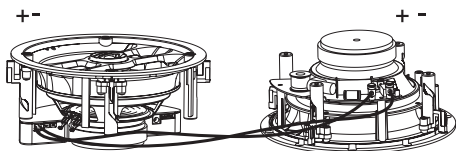

## Method 4 – Switch 2 Audio Sources

### Wi-Fi mode:

After connecting with Wi-Fi, use the SmartSonix App to play audio and the speaker will automatically work in Wi-Fi mode. Or press the “Mode” button of the remote for several times until the LED light turns green to switch audio source to “Wi-Fi”.

### RCA mode:

Connect the speaker with an audio device like a phone or a computer by using a RCA cable and press the “MODE” button on the remote several times until the LED light turns cyan, or use the SmartSonix app to switch the audio source to “Line in” to switch to RCA mode.

## Care and Maintenance

- Turn off the power to the speaker when unused for long periods of time.
- Ensure all equipment is turned off prior to cleaning
- Surfaces need only occasional dusting/cleaning.
- Never use chemicals or solvents as they may damage the surface.
- Always clean using a dry cloth.
- Never touch the speaker drivers.



# C 0870A 165mm 2 Way Round WiFi Ceiling Speaker Pair

## Wi-Fi Compatibility

**If installing the speakers in an enterprise level network environment, please consult the network administrator or I.T. professional to ensure the network will allow the speakers to connect.**

### **For non-enterprise level networks such as residential and home networks:**

1. Please ensure the router has the 2.4 GHz Wi-Fi band enabled. The speakers will not connect with routers/access points that are ONLY on the 5ghz band.
2. Ensure the network's access points are not using WPA-Enterprise mode protocol. The speakers do not support WPA-enterprise mode.
3. Ensure the router has DHCP enabled.
4. Ensure the access points do not have a captive guest portal activated.
5. Ensure the access points are not using a hidden SSID.
6. Ensure the router is not using AP isolation, since the speakers will not appear in the search on networks with AP isolation security.
7. Ensure the router supports Multicast (IGMP).

## Wi-Fi Connection Hints:

### **1. Router Device Connection limit**

Some routers have a limit for the number of Wi-Fi devices that can be connected at one time – typically between 10 and 15 Wi-Fi enabled devices together. Please check the router specification to ensure that this device limit is not exceeded. A router which is overloaded, trying to accommodate multiple connected devices, may drop some devices off the network.

### **2. Limited Signal Coverage**

The further away the speakers are from the Wi-Fi router, the weaker the wireless connection, and the more likely that drop outs will occur. The speakers do require good Wi-Fi signal strength to operate. If the speaker location has poor Wi-Fi signal strength, then they may drop connection. Please relocate the Wi-Fi router/access point or add Wi-Fi extenders to improve signal strength. Alternatively, consider using the Master speaker's RJ-45 port to install a wired connection from the speaker to the router.

## Device Resetting:

If the multi-room network fails during operation, you can press the WPS button to restore the speaker to its original factory default settings. Uninstall the Wi-Fi speaker from the ceiling and press the WPS button for around 10 seconds. During this operation, make sure the speaker is power switched on.

## Device Personal Setting:

- Rename: If you find the Wi-Fi speaker is wrongly named after installation, you can rename the device as you see fit using the mobile App.
- Speaker info: To protect the speaker's Wi-Fi signal from being hacked by others, you can set a password for your device. The default password is C0870AAA.

# C 0870A 165mm 2 Way Round WiFi Ceiling Speaker Pair

## 5) Remote Control

Note: CR2025 lithium coin cell battery included.

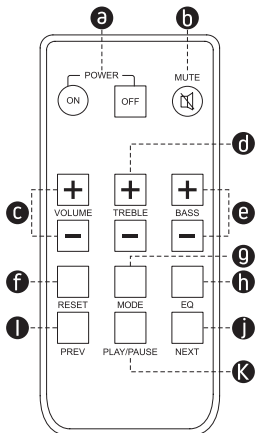

- a Power On/Off**  
Press to turn on/off the speaker.
- b Mute**  
Press to turn off the sound temporary, and press again to turn the sound back
- c Volume+/-**  
Press to increase or decrease the sound level. You will hear a beep when the volume reaches the highest or lowest level.
- d Treble +/-**  
Press to increase or decrease the high frequency response. You will hear a beep when the treble reaches the maximum or minimum value.
- e Bass +/-**  
Press to increase or decrease the low frequency response. You will hear a beep when the bass reaches the maximum or minimum value.

### f Reset

Press and hold to resume the speaker to default setting. All parameters will be reset to default values: volume is 26; sound effect is flat; treble and bass is 0.

### g MODE

Press to switch the audio source. Press it several times until the LED light turns green (Wi-Fi mode) or cyan (RCA mode)

### h EQ

Press to switch sound effects in order as Flat, Classical, Pop, Rock, Jazz, Vocal Enhanced.

### i Previous

Press for previous track.

### j Next

Press for next track.

### k Play/Pause

#### Note:

Only if the Wi-Fi input is activated, the PREV, NEXT and RESET keys can work.

#### Tips:

The infrared remote control has effective scope of operating range which is less than 3m(10 ft.)and at 60 degrees angle left or right away from the system.

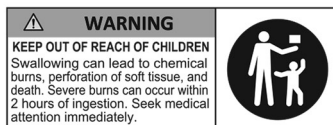
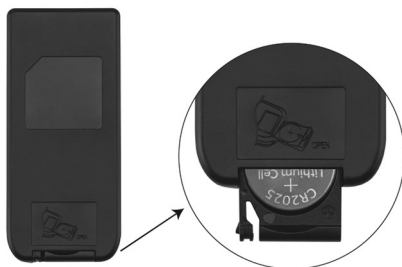

# C 0870A 165mm 2 Way Round WiFi Ceiling Speaker Pair

Altronic Distributors warrants this product for one year from date of purchase from Altronics or its resellers to the consumer. If this item is part of an installation or another product, please contact the installer or supplier for your warranty.

During the warranty period, we undertake to repair or replace your product at no charge if found to be defective due to a manufacturing fault. The warranty excludes damage by misuse or incorrect installation (i.e. failure to install and operate device according to specifications in the supplied instruction manual), neglect, shipping accident, or no fault found, nor by use in a way or manner not intended by the supplier.

For repair or service please contact your **PLACE OF PURCHASE**.

If this item was purchased directly from Altronics please make a warranty claim by:

**1. FOR MAIL ORDER CUSTOMERS (includes school and trade orders),**

a) Calling your nearest store location and quoting your tax invoice number.

b) Upon contacting Altronics, we will issue an R.A. (Return Authorisation). As Altronics have a number of service agents throughout Australia, a copy of the R.A. will be emailed, faxed or mailed to you with full instructions of how and where to send the goods. The freight for shipping goods back to Altronics for all repairs is at the customers expense.

c) A copy of the R.A. form, (or at the very minimum, the R.A. number) must accompany the goods to effect the repair.

d) Altronics will pay the return freight to the customer where the warranty claim has been accepted.

e) Please quote the R.A. number in any correspondence to us.

**2. FOR OVER THE COUNTER PURCHASES to make a warranty claim, please return the goods to us in any of our stores, with a copy of your proof of purchase (tax invoice).**

a) Upon leaving the goods at one of our stores, an R.A. number will be issued to you.

b) Once repaired, you will be contacted, advising that the goods are ready to be collected from the store.

It is at Altronics discretion as to whether the goods will be repaired or replaced (whilst under warranty); and as to whether identical goods will be used to replace the item due to changes of models / products.

Note: Under no circumstances should you attempt to repair the device yourself or via a non-authorised Altronics service centre, as this will invalidate the warranty!

Our goods come with guarantees that cannot be excluded under the Australian Consumer Law. You are entitled to a replacement or refund for a major failure and for compensation for any other reasonably foreseeable loss or damage. You are also entitled to have the goods repaired or replaced if the goods fail to be of acceptable quality and the failure does not amount to a major failure.